



the elegance that you dream...  
is now yours

MAHADEV  
**elegance**  
2 & 3 BHK  
PREMIUM LIVING & SHOWROOMS

WHERE  
YOU EMBRACE  
THE PRIVILEGED LIFE

A project that completely redefines the way you look at and live your life. These magnificent 2 & 3 BHK apartments elevate your lifestyle to an imperial level.



A location  
that connects you to  
everything that is important in life.  
There isn't a better address than this.







Celebrate your life at the  
Highest level of Happiness



**GROUND FLOOR PLAN**



**Amenities on Ground Floor**

1. ENTRANCE GATE
2. SECURITY CABIN
3. PICK-UP ZONE
4. DROP-OFF ZONE
5. EXIT GATE
6. MULTIPURPOSE COURT
7. BASEMENT RAMP
8. SPACE FOR SUBSTATION
9. BOX CRICKET
10. SENIOR CITIZEN SIT-OUTS
11. CLUB HOUSE
  - 11.1 MULTIPURPOSE HALL (GROUND FLOOR)
  - 11.2 GYM (UPPER FLOOR)
12. UTILITY AREA
13. PROJECTION SCREEN
14. BIRD FEEDER
15. EVENT LAWN
16. GAZEBO
17. SPLASH POOL
18. INDOOR GAMES
19. SOCIETY OFFICE
20. LIBRARY
21. CHILDREN PLAY AREA
22. RAMP
23. YOGA DECK / EVENT STAGE



TYPICAL  
FLOOR PLAN

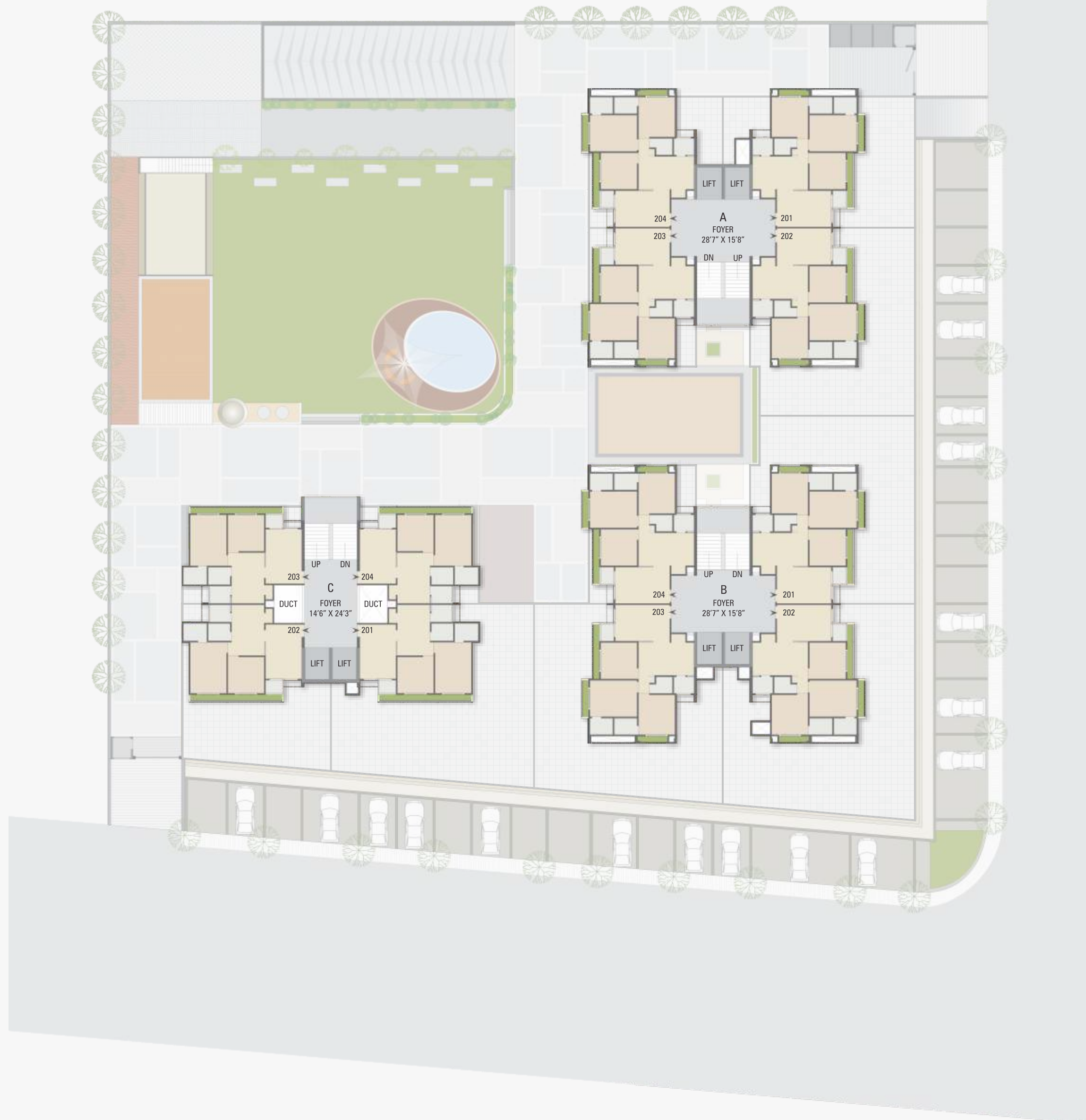

**3 BHK**  
UNIT PLAN | BLOCK - A & B



1	DRAWING ROOM	15'0" X 10'0"	5	BEDROOM	10'0" X 10'0"
2	BALCONY	4'0" X 5'0"	6	M. BEDROOM	10'0" X 11'0"
3	KITCHEN/DINNING	15'3" X 9'0"	6A	TOILET	6'3" X 4'6"
3A	STORE	4'0" X 2'0"	7	M. BEDROOM	13'0" X 10'0"
3B	WASH	5'7" X 4'6"	7A	TOILET	6'3" X 4'6"
4	C. TOILET	6'0" X 4'6"			

**2 BHK**  
UNIT PLAN | BLOCK - C



1	DRAWING ROOM	10'0" X 15'0"	4	C. TOILET	6'0" X 4'9"
2	BALCONY	5'0" X 4'0"	5	BEDROOM	10'0" X 10'0"
3	KITCHEN/DINNING	9'0" X 14'0"	6	M. BEDROOM	10'0" X 14'0"
3A	STORE	2'0" X 4'0"	6A	TOILET	6'6" X 4'9"
3B	WASH	5'6" X 4'9"			





Not just cosmetic features,  
but a set of soulful AMENITIES



PNG Line in Kitchen



2 Elevator per block



Fire Safety



Ample Parking  
in Basement



D.G. Power Backup  
For Common



24 x 7 Security



Solar Power  
For Common



Rain Water  
Harvesting



C.C.TV Camera  
in Ground Area



### Specifications

- Vitrified flooring in every areas of flats.
- Granite platform with S.S. sink and glazed tiles upto lintel level.
- Decorative main doors and other are flush doors.
- Aluminum sliding windows.
- Glazed /Ceramics tiles up to lintel level in all bathrooms and C.P. fitting – jaguar or equaiant.
- Concealed copper wirring with sufficient electric point in all rooms.
- Inside putty finish  
100% acrylic paint for exterior.

### LOCATION

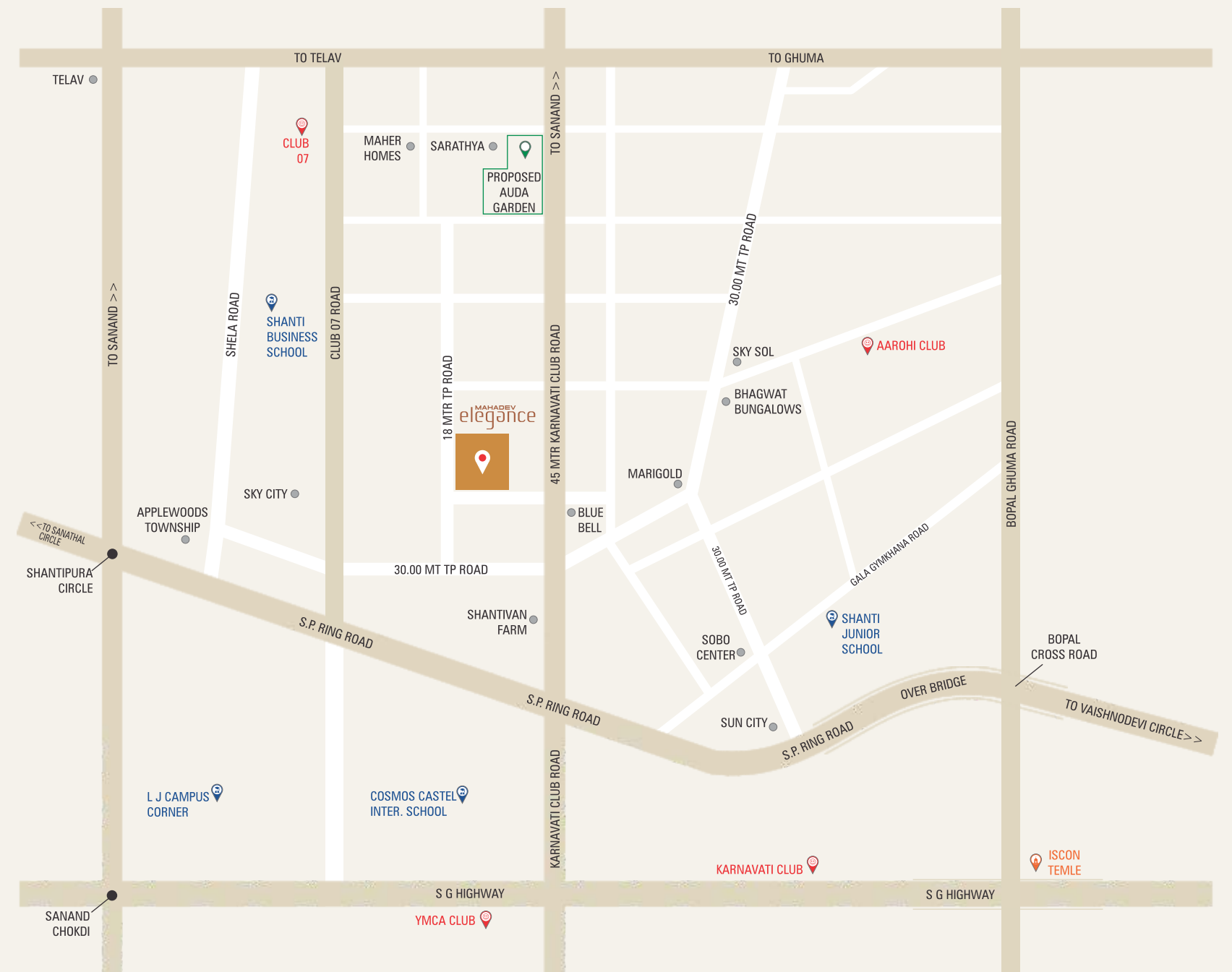

Scan for Location

### Disclaimer :

• All rights are reserved by the developers to make any changes in plan, elevations and other details which will be binding to all the members. • All dimensions shown in the plans are approximate, average unfinished and subject to variations. • The details, facts, specifications and amenities are mentioned are indicative for information purpose only and are subject to modification/compliance required as per RERA act. • All legal charges, government taxes shall be borne by the members. • This brochure is just for an easy presentation of the project and should not be treated as a legal document.

Rera : PR/GJ/AHMEDABAD/DASKROI/AUDA/MAA06438/091219 | www.gujrera.gujarat.gov.in.



a project by

**MAHADEV**  
LAND DEVELOPERS

MAHADEV  
**elegance**

Opp. Blue bell Office,  
45 MTR. Karanavati Club Road,  
Close to S.P Ring Road,  
South Bopal-Shela, Ahmedabad.

+91 92651 20459

[www.mahadevelegance.com](http://www.mahadevelegance.com)



With Blessings of



**radhe upavan**  
resort

Jasoda Highway, Hathijan,  
Ahmedabad-382445, Gujarat  
Contact : 079-25 84 29 00, 9925 13 62 62  
[inquiry@radheupavanresort.com](mailto:inquiry@radheupavanresort.com)  
[www.radheupvanresort.com](http://www.radheupvanresort.com)